



Manfrotto

Fix the camcorder onto plate "L" (figure 6) by screwing camera 1 /4" screw "K" or 3/8" screw "P" into the camcorder's threaded hole WITHOUT APPLYING FORCE (using for example a coin)

If the camcorder has a hole for anti-rotation, insert the pin "H" (fig. 1) on the hole before screwing camera screw

Before fully locking, align the camcorder lens with mark "LENS" on the camera plate "L"

POSITIONING THE CAMERA ① ⑦ ⑧ & ⑨

Insert the camera plate "L" as shown in figure 7 on top of the head until locking button "N" clicks.

 hold the camcorder during the follow operation to prevent it from slipping backwards and forwards.

Find the balance point for the horizontally positioned camcorder:

Level the head on the tripod using the spirit level "Q" (fig. 1)

With the locking knob "M" (fig. 1) unlocked, the tilt position lock knob "AG" open and the tilt drag knob "G" set at zero, slide the camcorder until find the horizontal position (fig. 8 and 9)

Lock the plate "L" (fig. 1) in the position reached by screwing the locking knob "M" (fig. 1)

BALANCE THE CAMERA ⑩

With one hand tilt the head back forwards (fig. 10) and forwards, with the other hand turn knob "AC" (fig. 1) clockwise until the head, when released, balances.

SPECIAL CHARACTERISTIC OF THE BALANCED MECHANISM: "CENTRING"

If the balance adjustment has been done at any angle between the horizontal and the point of greatest tilt, the camera will, on being further tilted, return at a lesser angle.

COUNTERBALANCE GRAPHIC ⑪

The graph indicates how the balance system for the 526 head will perform, as a function of the weight of the camera and of the distance of its centre of gravity from the supporting surface.

REMOVE THE CAMCORDER FROM THE HEAD ⑫

 Whenever the camcorder needs to be removed from the head, unlock lever "M", hold the camera securely in one hand while operating safety button "N" with the other hand.

USE ①

The head features 360° pan and vertical tilt (+75° / -70°) which are controlled using the pan bar "A"

The head has 3 switchable degrees of drag plus free movement which can be set with gear "AF" for pan, knob "G" for tilt.

The pan movement can be locked using the knob "AE"

The tilt movement can be locked using the knob "AG"

NOTE

The level of pan and tilt drag required, will depend on:

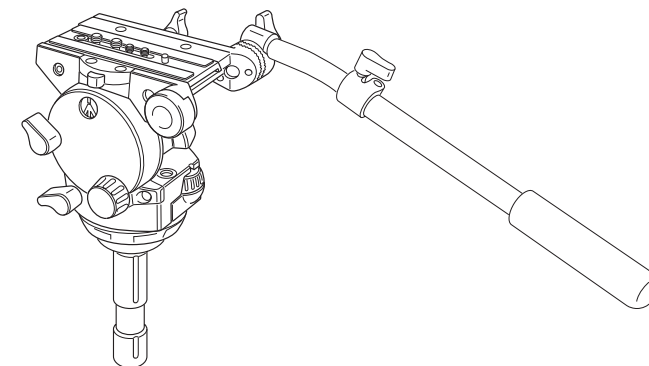

- the weight of the camera used
- the speed of movement required
- the environment temperature

 The position of the locking knobs "M", "AE" and "AG" can be modified by unscrewing the screw at the edge of the knob, with Allen key "X" supplied with head, extracting the knob and reinserting it rotated 1/6 of turn in a more comfortable position.



INSTRUCTIONS

526

		
15 cm 5.9"	6,6 kg 8 lbs	16 kg 35.3 lbs

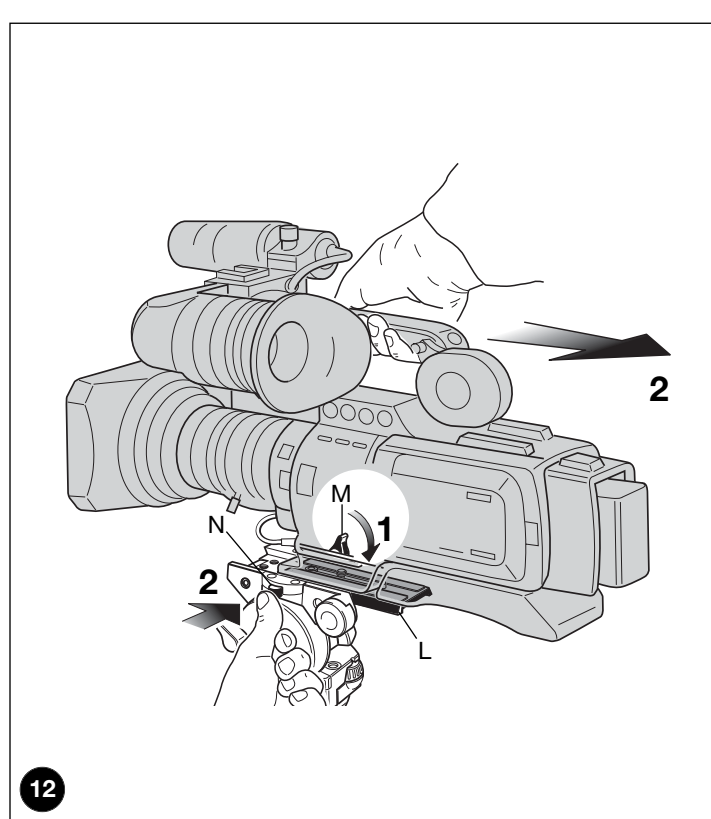
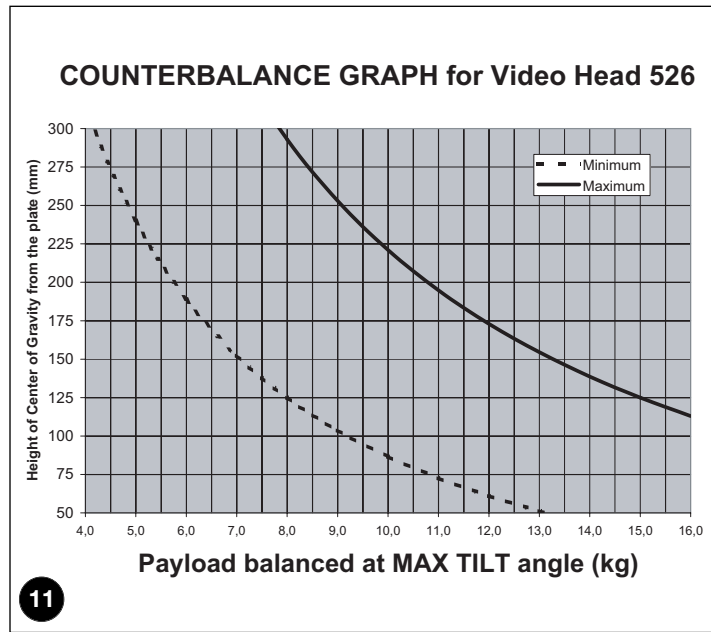
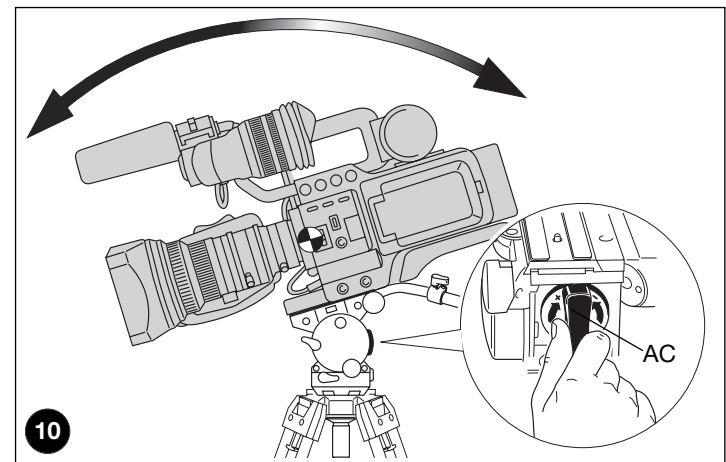
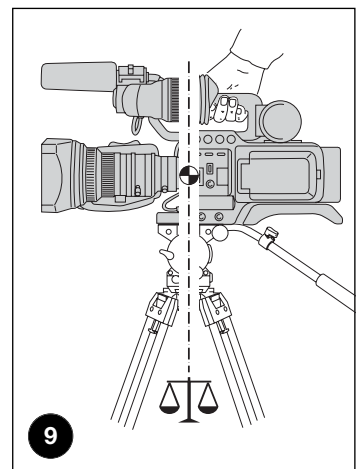
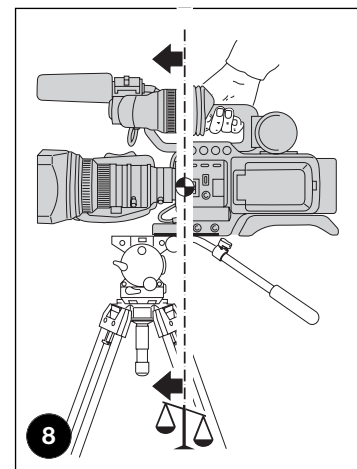
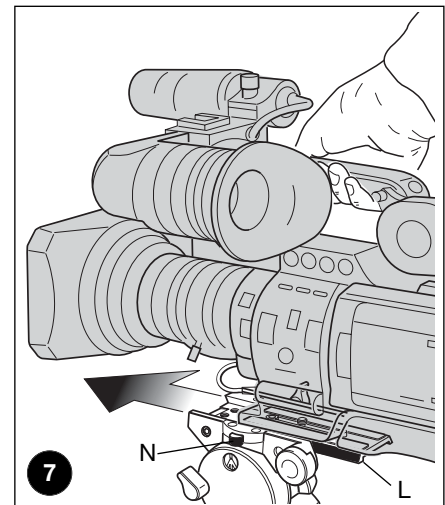
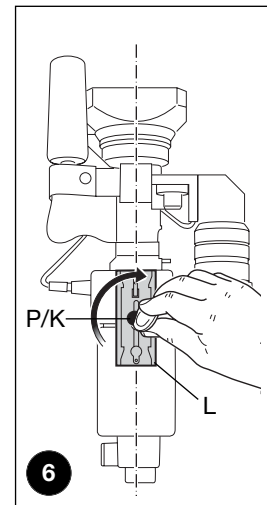
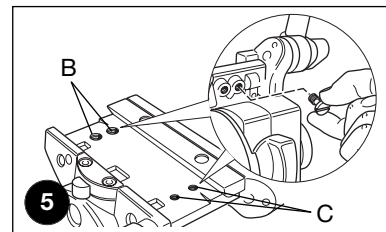
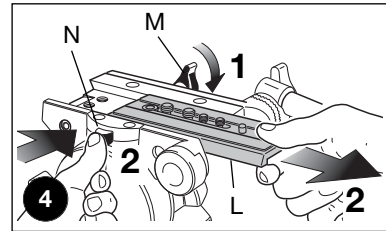
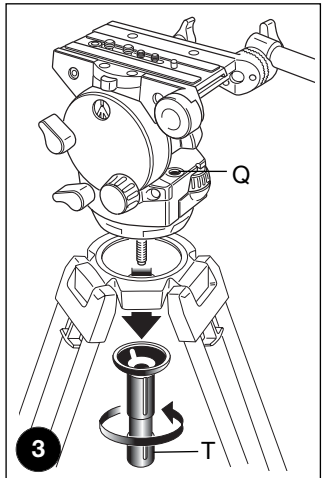
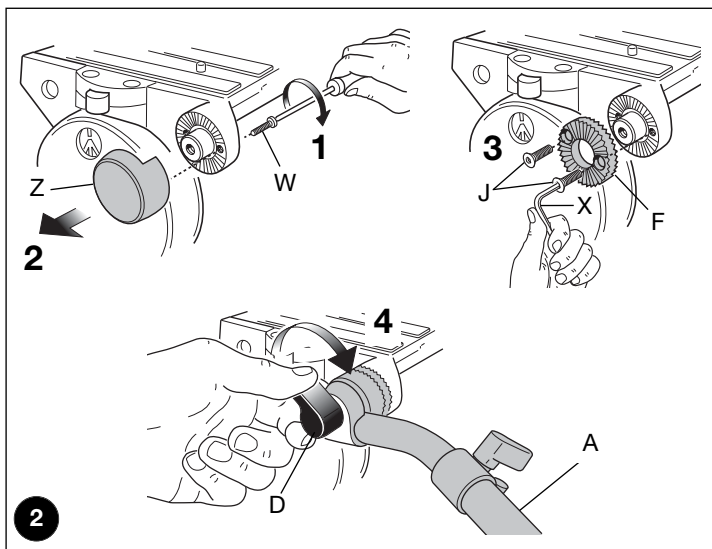
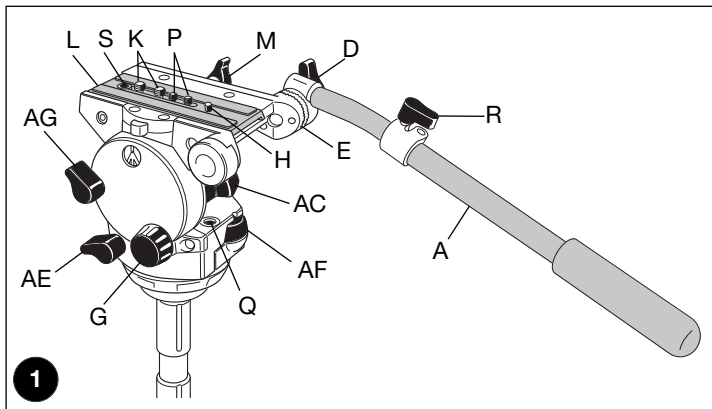

INTRODUCTION
 Designed for digital ENG camcorder for loads up to 16kg (35.3 lbs).

KEY FEATURES

- Quick release sliding plate for balancing the camcorder with secondary safety latch
- 2 x 1/4"W and 2 x 3/8"W camera screws and pin
- 100 mm head bowl
- Pan drag adjustment: 0 to 3 steps
- Tilt drag adjustment: 0 to 3 steps
- Telescopic pan bar can be fitted left or right
- Spirit level for fine levelling
- Variable balance control

SET UP 1 & 2
 The head is supplied with the telescopic pan bar "A" dismantled. It can be mounted as shown in figure 1 by screwing knob "D" in the teeth-washer "E".
 The teeth-washer "E" is specially designed to allow the pan bar to be positioned at intervals of 10 degrees. The pan bar "A" is telescopic and can be extended by means of knob "R" (fig. 1).

The head is supplied with second teeth-washer in order to mounted the pan bar "A" in the other side or to mount a second pan bar (available as an optional):

- unscrew the screw "W" (fig. 2)
- remove plastic protection "Z"
- fix the second teeth-washer "F" by screwing the two screws "J" using Key Allen "X" supplied with the head
- mount the pan bar "A"(or a second pan bar) by screwing knob "D"

The additional teeth-washer "F" can be used also as a spare part to replace teeth-washer "E" (fig. 1) already mounted in case of damaging

MOUNTING THE HEAD ON A TRIPOD 3
 The head can be mounted on tripods with 75mm diameter bowl. To mount the head on tripod head see fig. 3:

- unscrew grip "T"
- place the head into the tripod bowl
- screw grip "T" up against the bowl, but do not tighten it
- hold grip "T" and level the tripod head using the spirit level "Q" as a reference
- tighten grip "T" fully to lock head to tripod

To mount the head on a tripod with 3/8" screw fixing, use MANFROTTO 325 (USA 3114) adaptor which is an optional extra.

REMOVE QUICK RELEASE PLATE FROM HEAD 4
 Extract plate "L" realising the locking knob "M" whilst pushing button "N" at the same time as shown in figure 4.

ASSEMBLING CAMCORDER ON PLATE 4 & 5
 The head (fig.1) is supplied with 1/4" camera screws "P" and 3/8" camera screws "K" on the plate "L". To remove the screws not used proceed as follow (fig. 1)

- lightly press the rubber cap "S" with your finger
- remove the screws not used
- reposition the cap "S" to prevent the screws from being lost

NOTE
 The head is provided with threaded housing for the screws not used, see figure 5 (holes "B" for 3/8" screw "K" and holes "C" for 1/4" screw "P")